

GUIDE TO THE PIXY MINI

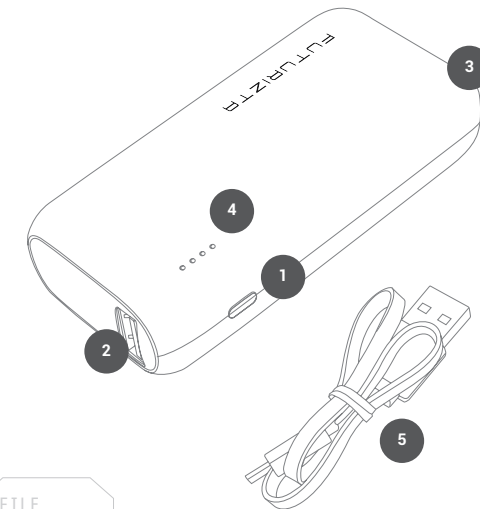

1. Power button
2. USB A output port
3. Type C output/input port
4. LED Indicators
5. USB-C charging cable



1 CHECKING BATTERY CHARGE

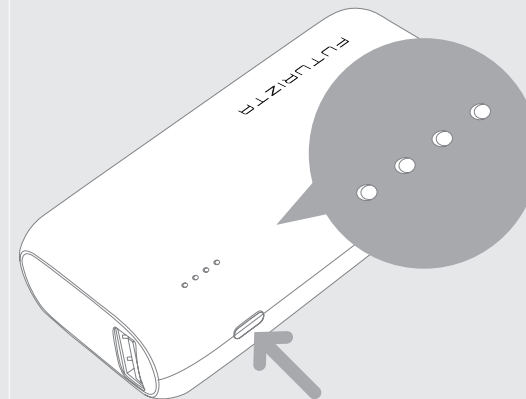

LED indicator lights Indicate the remaining battery charge that the power bank contains. Press the POWER button to check battery status. There are 4 LEDs with each LED representing 25% of charge.

2 CHARGING YOUR PIXY MINI

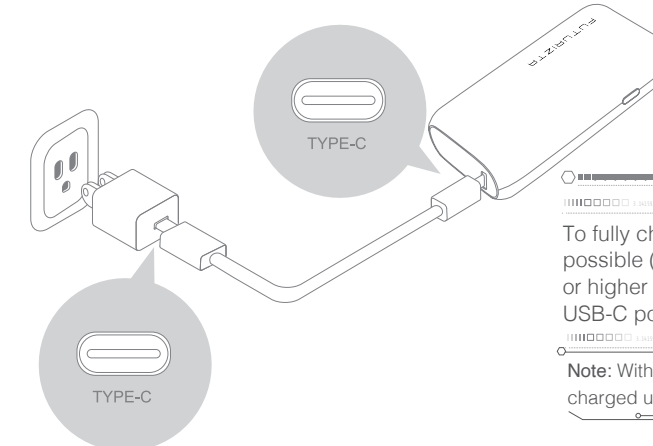

To fully charge up your Pixy Mini at the fastest speed possible (1.5 hours), please use a compatible **18W** or higher PD charger to fast charge Pixy Mini via the USB-C port.

Note: With a normal 2.4A charger, Pixy Mini will be charged up in 2.5 hours.

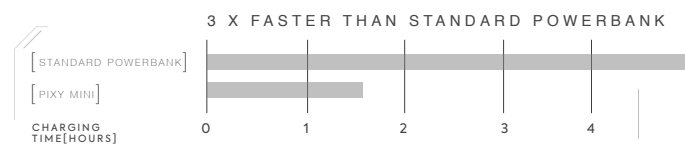

3 CHARGING YOUR DEVICES

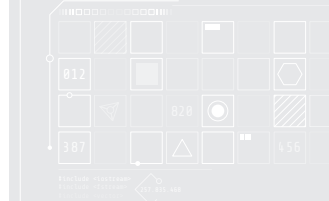

Pixy Mini has both **USB-C** and **USB-A** output and with the compatible cable connected to your device, it automatically triggers the charge.

Dual Output capability allows you to simultaneously charge 2 devices at the same time with a combined max output of 20W.

Low Current Charging Mode
Double click the power button to activate low current charging mode for low-power devices such as wireless earphones, speakers, smartwatches etc.

CONTACT FOR SUPPORT

Futurizta is a Tech Company that innovates gadgets from listening and tending to consumer's needs. We hold on to a core belief that futuristic means to have more out of something simplistic. For more info or support, please visit our website at futurizta.com and use our pop-up chat box or simply reach us at info@futurizta.com.

All rights reserved. Any information printed here is subject to change without notice. Pixy Mini and the Futurizta Tech logo are trademarks of Futurizta Tech Pty Ltd.

f FUTURIZTATECH

IG FUTURIZTATECH.OFFICIAL

Twitter FUTURIZTA

Website FUTURIZTA.COM



This symbol, affixed to the product or its packaging, indicates that the product must not be processed as household waste. This product should be correctly disposed of according to your local guidelines for electrical and battery operated products. Correct disposal of the battery will avoid potential harm to the environment and human health. For further information regarding the recycling of this product, please contact your local waste recycling centre.

4 PASS-THROUGH CHARGING

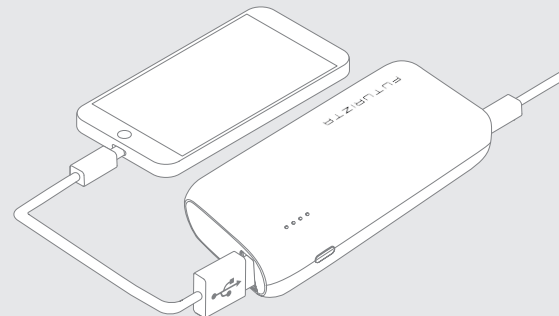

Pass-through charging capability allows you to charge other devices while charging Pixy Mini itself.

Note: Fast-Charging is disabled during pass-through charging to protect the battery and reduce heat. Pass-through charging is ideal for overnight charging to fully charge your device and Pixy Mini simultaneously. To get the fastest charging speed possible, please charge Pixy Mini and your devices separately.

5 DAISY CHAIN

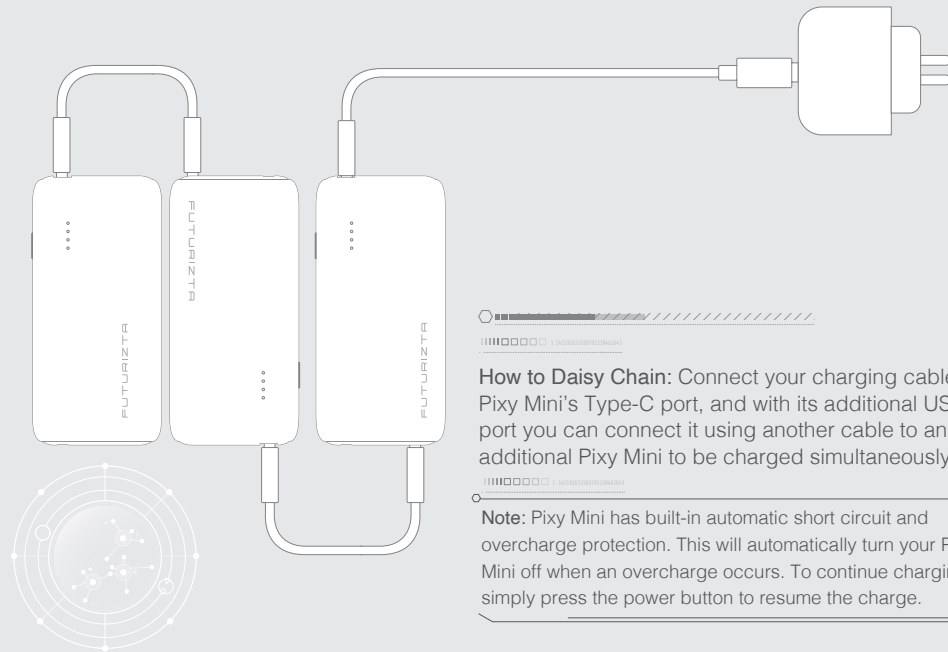

How to Daisy Chain: Connect your charging cable to Pixy Mini's Type-C port, and with its additional USB-A port you can connect it using another cable to an additional Pixy Mini to be charged simultaneously.

Note: Pixy Mini has built-in automatic short circuit and overcharge protection. This will automatically turn your Pixy Mini off when an overcharge occurs. To continue charging, simply press the power button to resume the charge.

6 FEATURES

- 20W Power Delivery (USB-C) :** Fast charge compatible devices from 0-60% in 30 minutes
- QC3.0 (USB-A) :** Fast charge your compatible Android devices from 0-80% in 30 minutes
- Ultra-Light & Portable:** Smaller than a credit card and weighs only 98g/3.45oz.
- 5000 mAh:** Charge your phone 1 - 1.5 x time
- 18W PD Input (USB-C):** Fully charge your Pixy Mini in 1.5 hours (3 x faster than standard powerbank)
- Dual Output:** Charge 2 devices at once with Type-C for your modern devices and USB-A for your older devices.
- LED Indicator:** 4 LED Indicators to display the available battery capacity.
- Low Power Mode:** Smart integrated chip allow you to charge your low-powered devices fast and securely.

SPECIFICATION

Product name :	PIXY MINI
Model name :	PBX5000
Capacity :	5000 mAh / 3.7V
USB-C output :	5V/2.4A, 5V/2.2A ,9V/2.2A, 12V/1.5A
USB-A output :	5V/2.4A, 9V/2A, 12V/1.5A
USB-C input :	5V/2.4A, 5V/2.2A , 12V/1.5A
Size :	7.5cm x 3.5cm x 2.5cm 2.9in x 1.18in x 1in
Weight :	98G 3.45oz

7 MAINTENANCE AND SAFETY

- To maximize Pixy Mini's battery life span, we recommend fully charging Pixy Mini before first use.
- Store Pixy Mini in a cool and dry place.
- Do not store power bank in hot or humid environment .
- Operating temperature should be between -10°C to 45°C. When charging a device, the power bank may feel warm, this is a normal operating condition and should not be cause for concern .
- We recommend charging and discharging Pixy Mini at least once every 3 months.
- Do not dispose of Pixy Mini in heat or fire
- Do not clean Pixy Mini with harmful chemicals or detergents.
- Misuse, dropping or excessive force may cause product damage. Using a damaged product is not advised.

FUTURIZTA

MOST POWERFUL
FOR ITS SIZE

PACK LIGHT, GO FAST

THE FUTURE · CONNECTED